

# TOOL CLIPS

TCO, TCC, SLM



## TYPE TCO, OPEN TYPE

Material: Spring steel CK 67

Finish: Bright zinc (FZB)  
Plastic coated PVC, Black



## TYPE TCC, CLOSED TYPE

Material: Spring steel CK 67

Finish: Bright zinc (FZB)  
Plastic coated PVC, Black

To grip	Mounting hole	FZB Cat.no	PVC Cat.no
6-9	2,4	7500	7510
10-12	2,4	7501	7511
13-15	2,4	7502	7512
16-18	2,4	7503	7513
19-24	3,2	7504	7514
25-27	3,2	7505	7515
28-31	3,2	7506	7516
32-37	3,2	7507	7517
38-50	3,2	7508	7518
51-60	3,6 x 2	7509	7519

To grip	Mounting hole	FZB Cat.no	PVC Cat.no
6-9	2,4	7520	7530
10-12	2,4	7521	7531
13-15	3,2	7522	7532
16-18	3,2	7523	7533
19-24	3,2	7524	7534
25-27	3,2	7525	7535
28-31	3,6	7526	7536
32-37	3,6	7527	7537
38-50	4,0 x 2	7528	7538
51-60	4,0 x 2	7529	7539

## TYPE SLM

Clips for fast and simple locking of shaft pins. Can also be used for fitting gas springs, see fittings on pages 178-188.

Material: Spring steel CK 67

Finish: Galvanised and yellow chromated

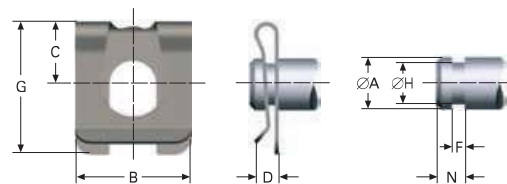

Shaft A	B	C	D	F	G	H	N	Maximum axial force, N	Cat.no
4	7	4	2,2	0,64-0,74	8,75	3,1-3,2	1,9-2,1	1000	9373
5	9	4,5	2,3	0,64-0,84	11	3,9-4,1	2,4-2,6	1300	9374
6	11	6	3,3	0,64-0,84	14,25	4,9-5,1	2,9-3,1	1500	9375
8	14	8	3,5	0,80-1,04	17,25	5,9-6,1	3,5-3,6	3600	9376
10	18	10,3	4,6	0,95-1,15	21,75	7,8-8,2	4,4-4,6	6400	9377
12	22	12	4,6	1,05-1,25	25,5	8,8-9,2	4,9-5,1	9600	9378